

# RCCN 日成MWS型夹线套 Narrow Wire Saddle-Arrowhead

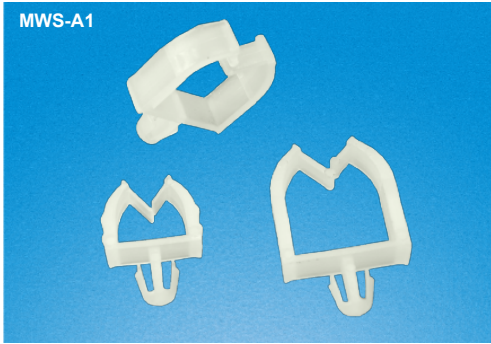

MWS-A1

材质：UL合格之NYLON66(本色)，防火等级94V-2，绝缘性佳，不易老化。  
 本品与MWS-A1/B1系列区别是开孔3.5。  
 Material：UL approved NYLON66(natural)，fireproof 94V-2，  
 good insulation,good aging resistant.  
 The difference between this product abd MWS-1A/B1 lies in the hole is 3.5

单位/Unit:mm

型号 Item No.	A	B	孔径 Hole dia.	板厚 Board thickness	包装 Packing
MWS-A-7.3	7.3	6.7	3.0	1.6	1000pcs
MWS-A-9.1	9.1	8.2	3.0	1.6	
MWS-A-11.2	11.2	9.4	3.0	1.6	
MWS-A-13.0	13.0	9.4	3.0	1.6	
MWS-B-7.3	7.3	6.7	3.0	2.4	
MWS-B-9.1	9.1	8.2	3.0	2.4	
MWS-B-11.2	11.3	9.4	3.0	2.4	
MWS-B-13.0	13.0	9.4	3.0	2.4	

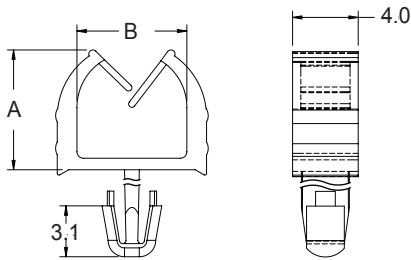

单位/Unit:mm

型号 Item No.	A	B	孔径 Hole dia.	板厚 Board thickness	包装 Packing
MWS-A2-7.3	7.3	6.7	3.5	1.6	1000pcs
MWS-A2-9.1	9.1	8.2	3.5	1.6	
MWS-A2-11.2	11.2	9.4	3.5	1.6	
MWS-A2-13.0	13.0	9.4	3.5	1.6	
MWS-B2-7.3	7.3	6.7	3.5	2.4	
MWS-B2-9.1	9.1	8.2	3.5	2.4	
MWS-B2-11.2	11.3	9.4	3.5	2.4	
MWS-B2-13.0	13.0	9.4	3.5	2.4	

# RCCN 日成NWS/LWS型夹线套 Narrow Wire Saddle-Arrowhead

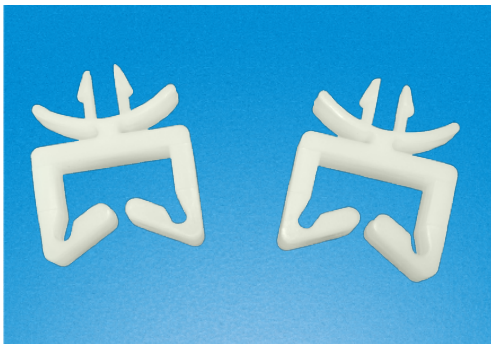

单位/Unit:mm

型号 Item No.	A	孔径 Hole dia.	板厚 Board thickness	包装 Packing
NWS-13	13.0	4.8	1.6	1000pcs
NWS-18	18.0	4.8	1.6	
NWS-26.9	26.9	4.8	1.6	
NWS-34.8	34.8	4.8	1.6	

型号 Item No.	A	孔径 Hole dia.	板厚 Board thickness	包装 Packing
LWS2-13.0	13.0	4.8	1.6	1000pcs
LWS2-18.0	18.0	4.8	1.6	
LWS2-27.2	27.2	4.8	1.6	
LWS2-35.1	35.1	4.8	1.6	

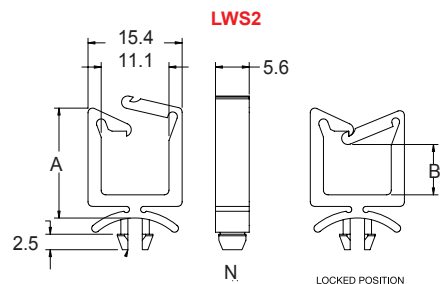
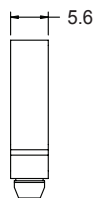
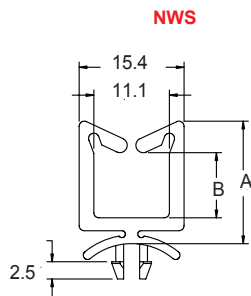

日成MWS型NWS型LWS型夹线套

Narrow Wire Saddle-Arrowhead